

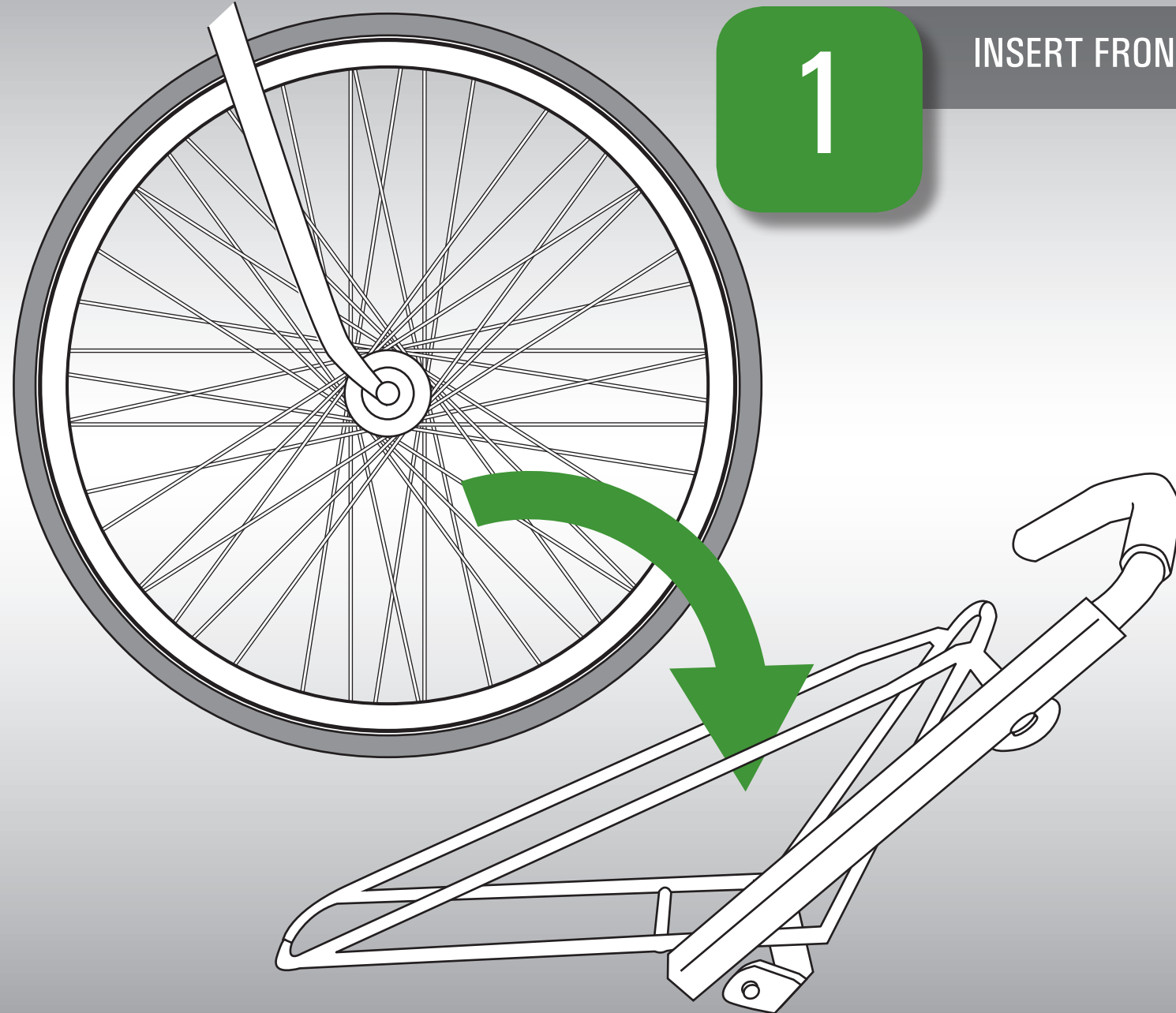

# FLOOR BIKE RACK INSTRUCTIONS

1

INSERT FRONT WHEEL INTO RACK



2

EXTEND RACK ARM

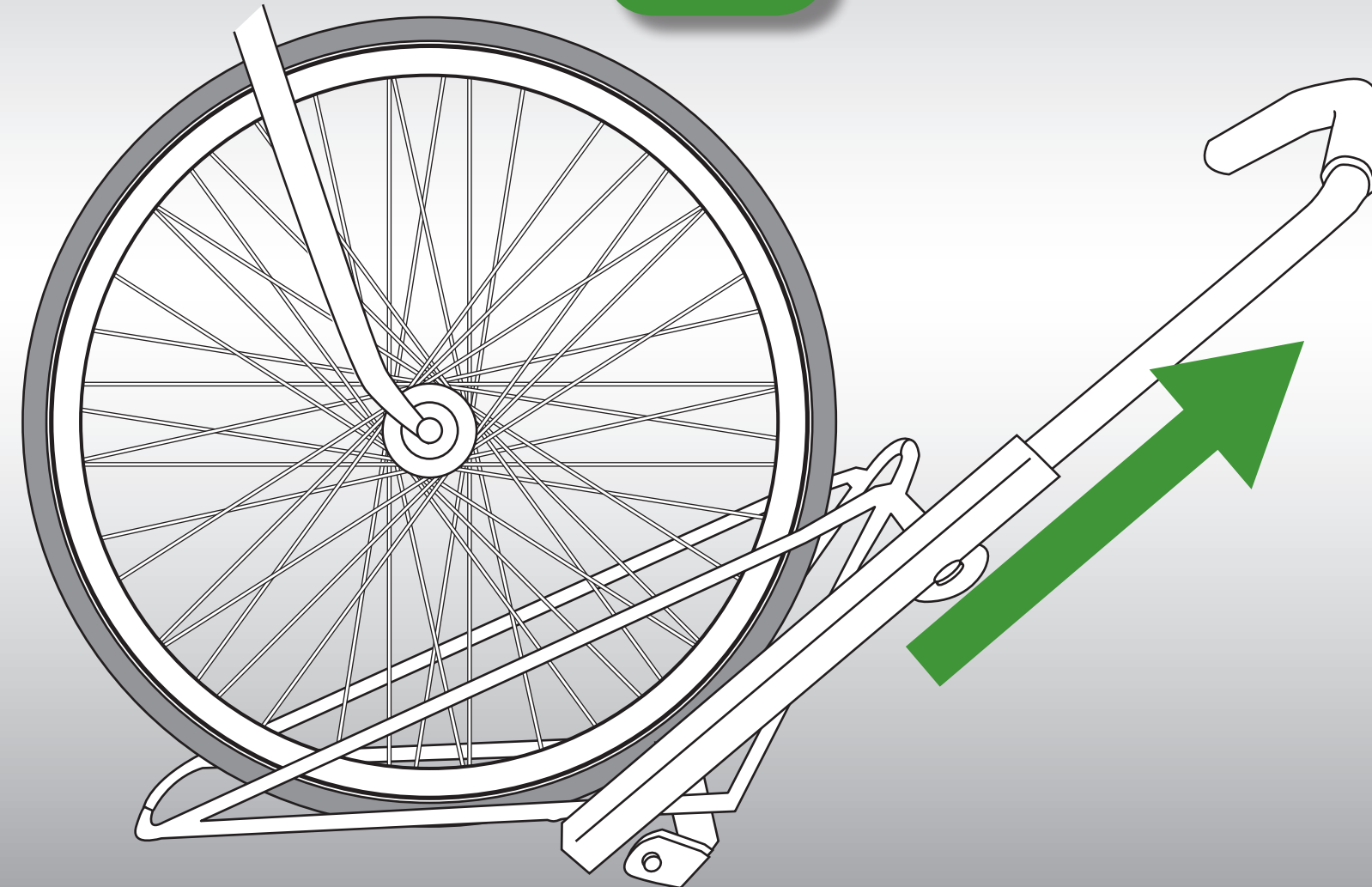

3

PULL RACK ARM BACK TOWARDS BIKE



4

PUSH RACK ARM DOWN SNUG TO TIRE

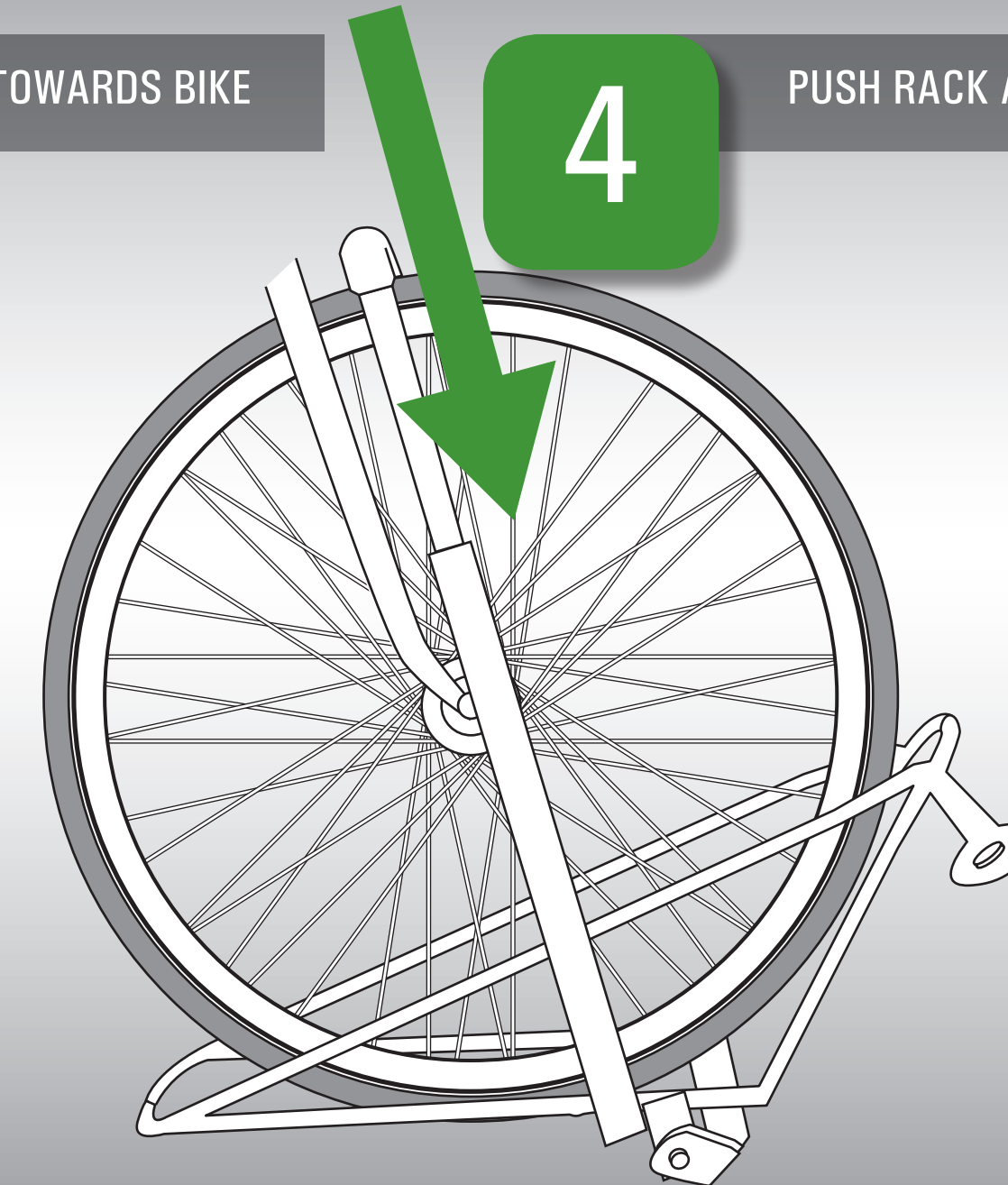

5

PLEASE MOVE  
YOUR REAR  
TIRE OUT OF  
THE AISLE.  
THANK YOU.

[ridetransfort.com](http://ridetransfort.com)

970.221.6620

TRANSFORT

